



Planetary Gearbox AM-22P Series

ASSUN MOTOR

2017 edition. Specifications are subject to change without notice.

GEARBOX CHARACTER

GEAR TYPE	Straight teeth	AVERAGE BACKLASH NO LOAD	<2°
OUTPUT SHAFT	Stainless steel hardened	RADIAL PLAY	<0.1
MAIN GEAR	alloy steel	PERMISSIBLE AXIAL LOAD	<40N
RING GEAR	Steel	PERMISSIBLE FORCE FOR PRESS FITS	<100N(5mm from mounting face)
ADAPTER PLATE	Copper	RECOMMENDED INPUT SPEED	<10000RPM
BEARING AT OUTPUT	Ball bearing	OPERATING TEMPERATRE RANGE	-20°C ~ +50°C
AXIAL PLAY	0-0.3	OPERATING HUMIDITY RANGE	10-90%RH
DIRECTIONS	CW/CCW		

GEARBOX DATA

NUMBER OF STAGE	1	2	3	4	5			
REDUCTION RATIO X:1	3.3 3.8 4.4 5.4	11 12 14 16 18	19 20 24 29	37 41 47 53 62 72 76 84 158	62 64 72 109 128	97 175 198 231 270 316 591 690 850 522 561	742 1014 1185 1386 1621 1996 2458 3027 3728 4592	
REDUCTION RATIO ABSOLUTE	63/19 15/4 57/13 27/5	3969/361 945/76 225/16 855/52 1701/95	3249/169 81/4 1539/65 729/25	250047/6859 59535/1444 3375/64 14175/304 12825/208 204687/3211 48735/676	1215/16 185193/2197 45927/475 87723/845 2187/20 41553/325 19683/125	212625/1216 50625/256 192375/832 731025/2704 2777895/8788 10556001/28561 531441/625	6561/16 5000211/10985 1240029/2375 2368521/4225 59049/100 1121931/1625 14348907/3125	759375/1024 10965375/10816 41668425/35152 158340015/114244 601692057/371293 285012027/142805 135005697/54925 63950067/21125 30292137/8125 14348907/3125
GEARBOX LENGTH "L" (mm)	22.5	27.6	32.6	37.7	42.6			
RATED TORQUE (Kgf.cm)	6	8	10	12	12			
BREAKING TORQUE (Kgf.cm)	18	24	30	36	36			
GEARBOX EFFICIENCY	93%	86%	80%	75%	70%			
MOMENT OF INERTIA RANGE (g.cm²)	0.5	0.4	0.5	0.4	0.5			
GEARBOX WEIGHT APPROX (g)	56	68	82	92	103			
GEARBOX MODEL	AM-22PA-X-01	AM-22PB-X-01	AM-22PC-X-01	AM-22PD-X-01	AM-22PE-X-01			

"X" Stand for RATIO

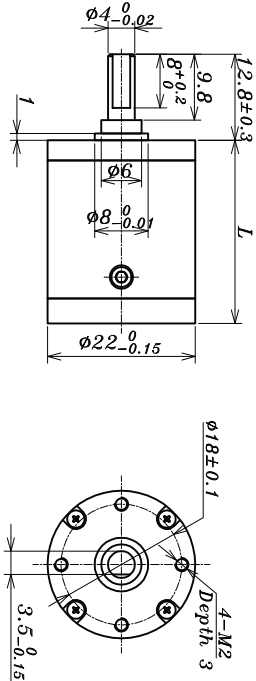

AM-22P EXAMPLE OF COMBINATION

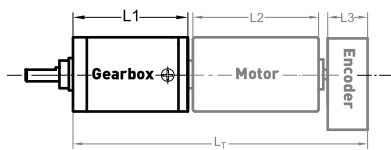

Recommend Motor:
Coreless Motor (w/E):
AM-CL2232MA/B
AM-CL2232GA/B
AM-CL2242MA/B
AM-CL2242GA/B
Brushless Motor (w/E):
AM-BL2040A/B
AM-BL2453A/B

Recommend Encoder:
Suitable for Coreless Motor
Encoder S: AM-EN22-S***
2 ~3 Channels
Suitable for Brushless Motor
Encoder S: AM-EN16-S***
2 ~3 Channels
Encoder T: AM-EN16/24-T***
2 ~3 Channels

INPUT GEAR DATA

MODULUS	0.35
PRESS ANGLE	20°
TEETH NUMBER	10 13 16 19
MAX GEAR HOLE "A"	1.5 2.0 3.0
MAX MOTOR SHAFT	1.5 2.0 3.0
MOTOR DIMENSION "D"	6.15 8.0

MOTOR DIMENSION

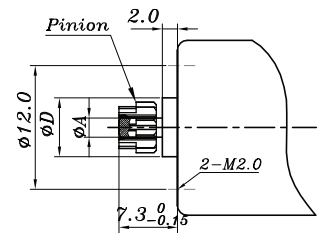

GEAR MOTOR LENGTH "LT"

GEAR MOTOR LENGTH LT	GEARMOTOR LENGTH L1	MOTOR LENGTH L2	ENCODER LENGTH L3
22.4	22.4	32	12
27.6	27.6	42	10.7
32.6	32.6	40	10
37.7	37.7	53	7.1
42.6	42.6	53	7.1

For more motor and encoder specs' see Assun Motor website.

REMARKS

Clients can choose gearbox and encoder to match with this motor. Some combinations are listed here for reference.

Motor Data Tested at 25°. Motor Operation exceeds continuous limits of operating range will compromise the life of the device.