

Serie 17 P

17 P Series

| CARATTERISTICHE GENERALI - General Characteristics | | | | | | | |
|--|-----|------|------|------|------|------|------|
| Tipo Type | | 17PC | | | 17PL | | |
| Tensione Nominale Rated Voltage | V | 24 | | | 24 | | |
| Velocità Nominale Rated Speed | Rpm | 3700 | 2900 | 3300 | 1500 | 2500 | 1100 |
| Potenza Nominale Rated Power | W | 12 | 9 | 19 | 8 | 10 | 5 |
| Codice di Avvolgimento Winding Code | | 060 | 066 | 030 | 078 | 083 | 085 |

| CARATTERISTICHE TECNICHE - Technical Characteristics | | | | | | | |
|--|-----------------------|-------|-------|-------|-------|-------|-------|
| Coppia Continuativa di Stallo Continuous Stall Current | Nm | 0,045 | 0,045 | 0,06 | 0,07 | 0,06 | 0,05 |
| Corrente Continuativa di Stallo Continuous Stall Torque | A | 1,4 | 1 | 1,7 | 0,95 | 1,3 | 0,75 |
| Coppia Nominale Rated Torque | Nm | 0,03 | 0,03 | 0,055 | 0,05 | 0,04 | 0,04 |
| Corrente Nominale Rated Current | A | 1 | 0,75 | 1,3 | 0,55 | 0,8 | 0,35 |
| Coppia di Picco allo Spunto Start Peak Torque | Nm | 0,075 | 0,05 | 0,11 | 0,075 | 0,08 | 0,075 |
| Corrente di Picco Start Peak Torque | A | 2,3 | 1,2 | 3,1 | 1 | 1,8 | 0,75 |
| Resistenza Totale Total Resistance | Ω | 7,9 | 15,4 | 5,76 | 17,5 | 10,1 | 34,1 |
| Induttanza Inductance | mH | 4,16 | 6,49 | 3,09 | 11 | 5,25 | 18 |
| Costante di Coppia Torque Constant | Nm/A | 0,032 | 0,045 | 0,035 | 0,073 | 0,046 | 0,1 |
| Costante di Tensione Voltage Constant | V/10 ³ Rpm | 3,95 | 5,20 | 5,05 | 10 | 6,75 | 12,50 |
| Costante di Tempo Elettrica Electrical Time Constant | ms | 0,530 | 0,420 | 0,54 | 0,63 | 0,52 | 0,53 |

| DATI MECCANICI - Mechanical Data | | | | | |
|---|-------------------|----------------------|--|----------------------|--|
| Momento di Inerzia Moment of Inertia | Kg·m ² | 3,2·10 ⁻⁶ | | 5,2·10 ⁻⁶ | |
| Massa Mass | Kg | 0,3 | | 0,4 | |
| Massimo Carico Radiale Maximum Radial Load | N | 80 | | 90 | |
| Massimo Carico Assiale Maximum Axial Load | N | 40 | | 50 | |

| CARATTERISTICHE TERMICHE - Thermal Characteristics | | |
|--|----|--------------------------|
| Temperatura di Funzionamento Rated Temperature | °C | 0 ÷ 40 |
| Classe di Isolamento Type of Insulation | | F |
| Grado di Protezione Level of Protection | | IP44 |
| Montaggio Mounting | | In Aria / Free Still Air |

Dati rilevati a temperatura ambiente di 25° C e con temperatura massima del collettore di 115° C.

The data was obtained at a room temperature of 25 °C with 115°C on the commutator.

Servomotore - Servomotor

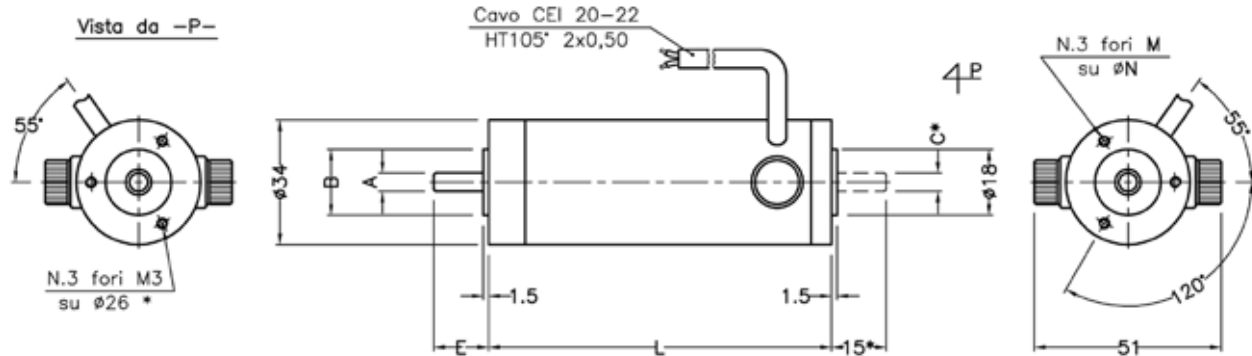

*Secondo albero a richiesta - Second shaft on request

Servomotore con dinamo tachimetrica - Tacho servomotor

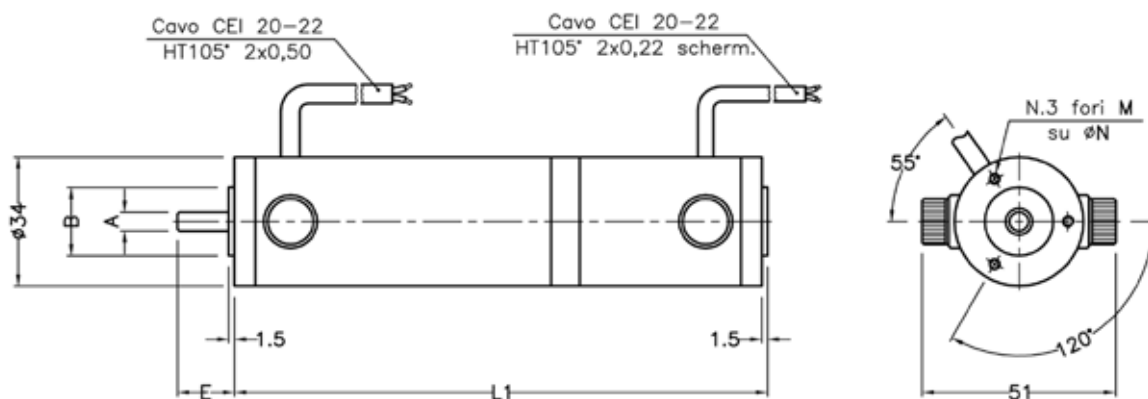

Tolleranze sulle dimensioni angolari : $\pm 5^\circ$
 The tolerance on angular dimensions: $\pm 5^\circ$

Optionals
Optionals

Encoder Modulare - Modular Encoder

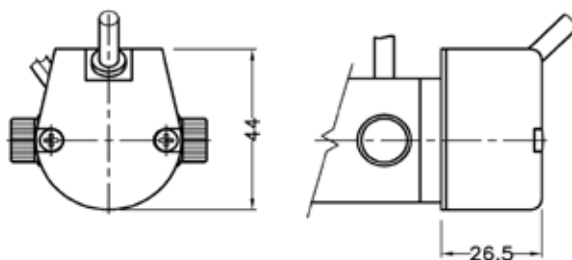



| DIMENSIONI - Dimensions | | | | | | | | | | |
|-------------------------|-----------------------------|-----------------|-----------------|-----------------|------------------|------------------|-------------------|----|----|---------------|
| Taglia Size | Tipo di Flangia Flange type | A ^{h6} | B ^{h7} | C ^{h6} | E ^{0,2} | L ^{0,5} | L1 ^{0,5} | M | N | Linguetta Key |
| 17PC | Standard | 5 | 18 | 5/6 | 15 | 74 | 121,5 | M3 | 26 | - |
| 17PL | Standard | 5 | 18 | 5/6 | 15 | 95 | 140,5 | M3 | 26 | - |

Caratteristiche Coppia-Velocità Torque-Speed characteristics

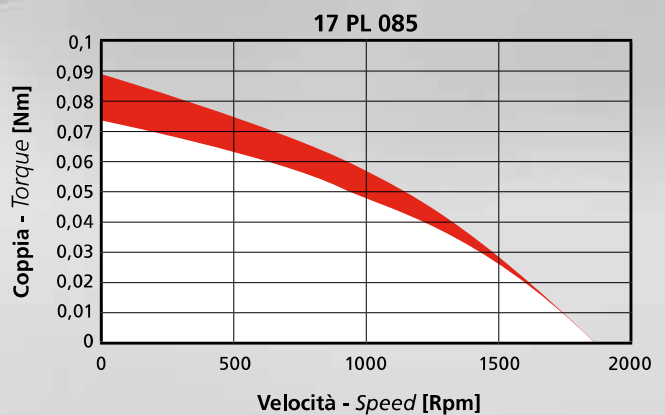
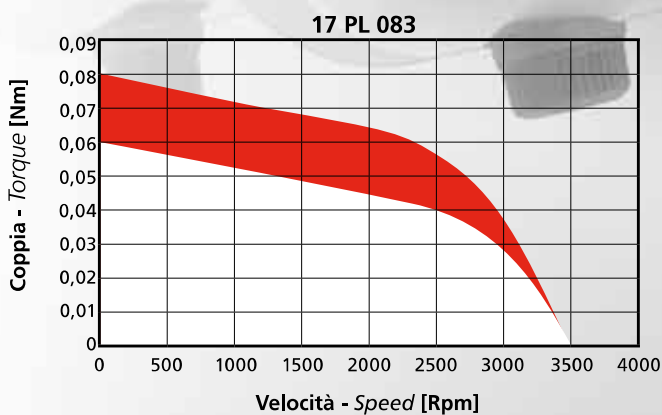
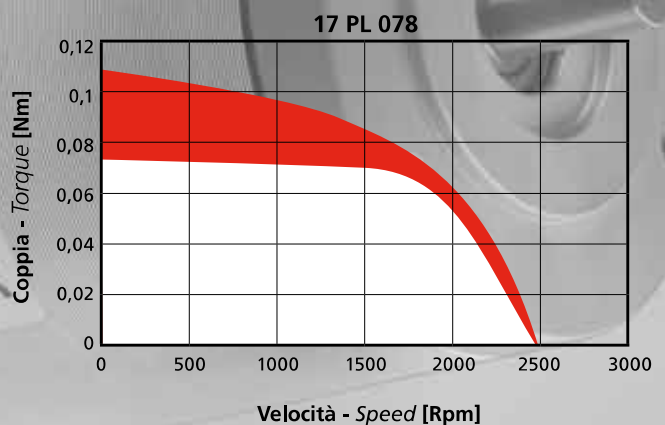
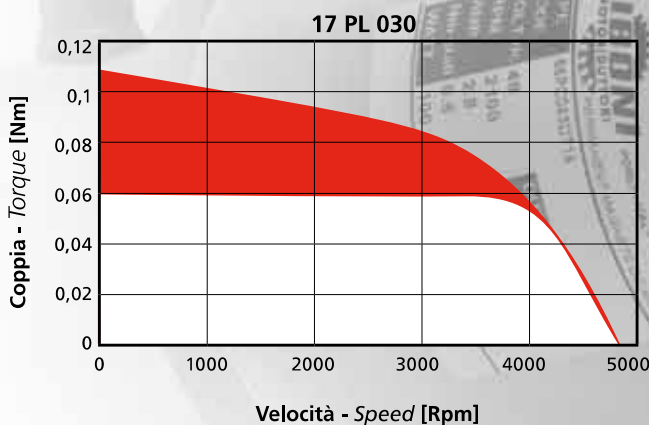
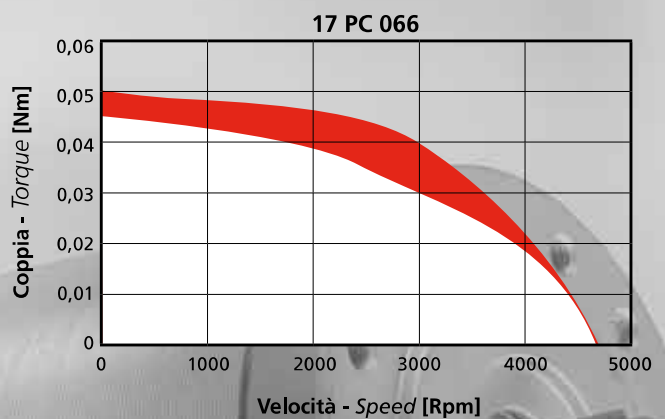
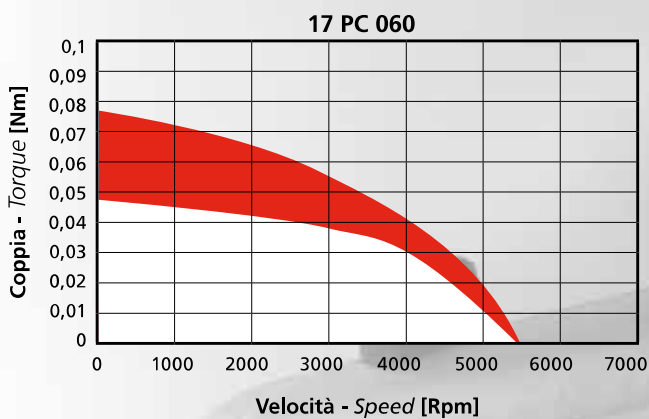

| | |
|--|---|
|  S1 |  S2, 50% 30 min. |
|--|---|